

GUARDIAN-PATRIOT HOME OF THE WEEK

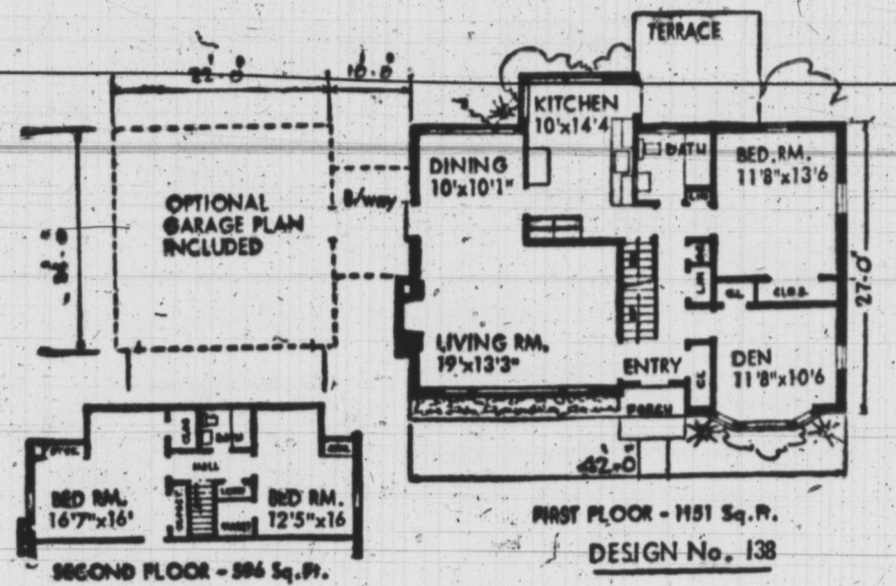

Double picture windows give a striking appearance to this popular one and a half storey design. Entry hall provides direct access to all parts of the house. Den could serve as an additional bedroom if desired. Large kitchen has ample table

space. Upstairs bedrooms are usually large and have plenty of storage closets. Second floor could be completed later when the extra space is required. Plans for the optional garage are supplied with the blueprints. Lower Fl. 1151 Sq. Ft. Upper Fl. 896 Sq. Ft.

DESIGN No. 138

HOW TO OBTAIN DESIGN BOOK

The latest design book entitled "101 Selected Suburban and Country Homes, Designed for Canadians," is now available at the offices of The Guardian and The Evening Patriot for \$1, tax free. This new edition includes color selection, etc., plus over 100 popular new designs to choose from. Also included are full designs on how to order blueprints.

... types or plans specifying which types of equipment work best under various circumstances. But you can't do better than go to the showrooms of plumbing manufacturers or plumbing contractors and see what's being made these days. It's quite remarkable. Usually there are both literature and advice available too. Suggestion: Get the very best quality you can afford. It will look better, last longer and be easier to maintain. Besides, the actual price difference won't be noticeable if you're swinging this on the installment plan.

DRY CRAWL SPACE
QUESTION: How can I be sure a crawl space will always be dry? We are considering a house near the shore, and I have heard that such areas are often so damp that mildew results.

ANSWER: Assume constant cross ventilation by having adequate louvers in each side of the crawl space wall (at least one square foot of louver for each 300 square feet of ground area; more won't hurt). Covering the area with concrete or overlapping layers of plastic sheeting will check rising ground dampness.

SAVING PAINT
QUESTION: How can I save partially used cans of paint so there won't be a scum forming on the top of the paint?

ANSWER: Many favorite methods. Most foolproof is to pour out paint into smaller container so that paint completely fills it. Another is to cut a circular sheet of aluminum foil, slightly larger than the diameter of the paint can and carefully fit it down on the paint's surface. Another popular method is to make the paint surface rise to the top of the can by dropping in clean, flat stones. Still another is to store the can upside down, making sure the top is tight.

QUESTION: My wife's white leather coat acquired a mark from a ballpoint pencil. How can I remove this?

ANSWER: Try wiping with carbon tet on a dampened cloth. Most of the time this works pretty well. Finish by rubbing with a good leather care emulsion-type cleaner. If the carbon tet doesn't get the major part of the stain out, consult a cleaner experienced in handling fine leathers.

BRASSING LIQUID
QUESTION: After a party we noticed a couple of white rings left by glasses which were set down on a polished coffee table. I have tried rubbing with sponge and cleanser, but with no results. What else can I try?

ANSWER: Dip in a small felt pad with camphorated oil. Then gently rub the white marks, following the grain of the wood as much as possible.

QUESTION: If this is heavy cast aluminum, heat the pan empty. The sudden expansion of the metal often cracks the deposit, so that it falls off in flakes. If this is a lightweight pan, fill with a strong solution of washing soda - enough to cover the deposit - for several hours. Then scrub with steel wool and soap.

GET BEST PLUMBING
QUESTION: I sent for plans for remodeling my bathroom and adding another. But nowhere could I find advice on the type of plumbing I should get. Are such plans available?

ANSWER: I know of no specific types or plans specifying which types of equipment work best under various circumstances. But you can't do better than go to the showrooms of plumbing manufacturers or plumbing contractors and see what's being made these days. It's quite remarkable. Usually there are both literature and advice available too. Suggestion: Get the very best quality you can afford. It will look better, last longer and be easier to maintain. Besides, the actual price difference won't be noticeable if you're swinging this on the installment plan.

Weekend Entertainment

Entertainment For The Whole Family At

RUSTICO GOLF CLUB

- Beautiful 18 hole Golf Course
- Horse back riding
- Free Tenting and Picnic Grounds
- Swimming & Boating
- Enjoy a Treat from our Restaurant
- Catering to private parties and wedding receptions



The best buys in equipment at our Pro Shop.

RUSTICO GOLF CLUB
Oyster Bed Bridge
Route 242

TOURISTS!

There's lots of room to camp

POINT PLEASANT PARK

150 acre park, for the best and warmest salt water bathing in Prince Edward Island. Excellent water skiing conditions, launching wharf for boats with outboard motors, picnic tables, clean rest rooms. The most picturesque park in Prince Edward Island with an assortment of island trees including pine and oak. Located two miles from Murray River on Murray River. Everyone Welcome.

First Aid For Ailing Houses

By ROGER C. WHITMAN

FURNACE CONVERSION

QUESTION: Some years ago (when I was younger and a healthier) I was willed a very nice house. It was the larger, older type which was built with pride in craftsmanship, and my family has been very happy and comfortable in it. But now I have definitely lost my enthusiasm for shoveling coal and hauling out ashes. I would like to convert either to gas or oil.

ANSWER: Your coal man is understandably trying to keep a good customer. But he is not right. When proper installation is done by a competent heating man, there should be no fumes in the house whatsoever, whether the heater be fueled by gas, oil, electricity or even coal.

STRAIGHTENING BEAM

QUESTION: The centre of our living room has begun to sag (this is an old house). I am planning to modernize the adjacent basement and get some use out of it, including a play room. At present the floor is packed earth, which may be the cause of the sagging beam, because the support post is apparently being pushed a little downward. I plan to put down a concrete floor. How can I shore up that sagging area in the floor?

ANSWER: Plan to transfer the support to a couple of adjustable metal posts. Before positioning them, dig out a hole for a concrete footing for each post. After thorough curing, set the posts in position and let them begin assuming the burden. Knock the old wooden posts out, then pour the concrete floor.

PAINT-STAINED DRESS

QUESTION: Some latex paint was accidentally brushed on a nice silk print dress. I hesitate to try different cleaners, for fear of using the wrong one and permanently damaging a favorite garment. What do you recommend?

ANSWER: If it's a favorite dress, I first recommend a good professional cleaner. The safest cleaning material of all - soap and warm water - should have been used immediately, while the paint was wet. It's still the first home-made remedy to try, although it will take considerably longer to work, now that the paint has hardened. If this doesn't work out, then try carbon tet. This is a very risky chemical to use unless you have full ventilation or better yet, do the job outdoors and avoid inhaling the poisonous fumes. I still think the first recommendation is the best, particularly if this is such a favorite dress.

EXPERIMENTAL SWITCH

QUESTION: One wall switch in my weekend cottage has been acting up. Sometimes when switch is off, the lights in the overhead fixture stay on. So amount of flipping will change this, and I have to climb up and unscrew each bulb. Then, next time, the switch works perfectly. What should I do?

ANSWER: Have it replaced. Such units are very inexpensive. If you are experienced, you might try to shut off the electricity and make the change. If you are not experienced, but know how to throw the main switch and are willing to proceed with utmost attention to

DRY ICE LOOSENS TILE

QUESTION: A friend told me you once described a method of using dry ice to remove asphalt tile from a floor. Since he didn't save this, and now I wish to do the job, I'll appreciate your repeating it.

ANSWER: The principle is making the tile adhesive so chilled it becomes brittle and loses its grip, and the tile can easily be pried up with a putty knife. Put about 15 pounds of dry ice in a burlap bag and leave it on your starting area for about 10 or 15 minutes. This should be enough for the intense chill to work through to the adhesive. As soon as the tiles begin to loosen, move the bag of ice to the adjacent area, so it can work while you continue prying up the tiles. With a little practice, you'll get them up almost like lifting a flapjack of the griddle.

(Note: All correspondence relating to home maintenance should be addressed to: Roger C. Whitman, c/o Toronto Star Syndicate, 80 King St. W., Toronto 1, Ontario.)

CLEANING ALUMINUM PAN

QUESTION: I would like to remove the blackened, burned deposit on the inside of an aluminum saucepan. All the scrubbing I can give it has no effect at all.

ANSWER: If this is heavy cast aluminum, heat the pan empty. The sudden expansion of the metal often cracks the deposit, so that it falls off in flakes. If this is a lightweight pan, fill with a strong solution of washing soda - enough to cover the deposit - for several hours. Then scrub with steel wool and soap.

GET BEST PLUMBING

QUESTION: I sent for plans for remodeling my bathroom and adding another. But nowhere could I find advice on the type of plumbing I should get. Are such plans available?

ANSWER: I know of no specific

ATTENTION Organizations and Commercial Firms

The "Gold Cup and Saucer" Parade will be held on Friday, August 19, 1966

Those interested in entering FLOATS are requested to complete the section below and send it to:
FLOAT COMMITTEE CHAIRMAN
G. W. Fichaud,
c/o R. T. Holman Limited
Charlottetown, P. E. I.

We wish to enter a Float in the 1966 Gold Cup & Saucer Parade.
(Briefly describe your intended float)

Name of Firm or Organization

Signature

Telephone No.

VISIT P.E.I. FAIRYLAND PARK
Located on Trans-Canada Highway in New Haven
10 miles from Charlottetown
Stroll through the fairytale forest and see and hear the beautiful world of fairy tales.
Or enjoy the playground designed for old and young.
There is something for everybody.
Open daily from 10 a.m. to 10 p.m.

TOWERS Restaurant
MALPEQUE RD. DIAL 1-4702
SUGGEST YOU TRY "Dixie Lee" FRIED CHICKEN
DIXIE SNACKS: 2 pieces of Chicken, Chips 75c
DIXIE DINNERS: 3 Pieces Delicious Chicken, Chips, Roll, Cole Slaw \$1.25
DIXIE BUCKETS: 12 Pieces Chicken, lot of Chips. Enough for 4-6 people. \$3.75
DIXIE BARRELS: 20 Pieces of Chicken, enough for 7-8 people. Great for Parties. \$4.95
Enjoy DIXIE LEE TAKE-OUT SERVICE

GO WHERE THE FUN IS!
VISIT SEAWOOD
Located 4 miles west of Cavendish on Highway No. 6
• BOATING • PEDAL BOATS
• MOTOR BOATS • ROW BOATS
Marine Supplies For Sale
Visit our new Snack Bar and Milk Bar
Serving Hot Dogs, Hamburgs, Soft Ice Cream, Cotton Candy for the Kids.
SEAWOOD ESTATES INC.
"The Fun Spot for All Ages"

STOCK CAR RACES
LOWER MONTAGUE RACEWAY
CANCELLED
For This Week Only
Watch This Paper For Further Announcements

a must! a visit to
"Thymewood"
STANHOPE P. E. I.
See the Island made
Model Ships
on display & for sale
PLUS
"HANDCRAFTS FROM THE FOUR ATLANTIC PROVINCES"